

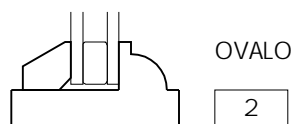

STANDARD DETAILS

Optional Profiles SHEET INDEX

<u>SHEET</u>	<u>WINDOW TYPE</u>
	Ø OTHER DETAILS
2.41-2.42	STICKING PROFILES
2.51	STOOL PROFILES

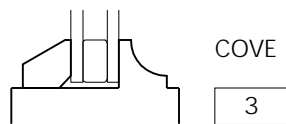
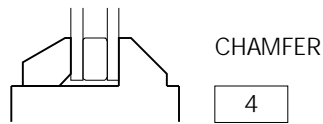
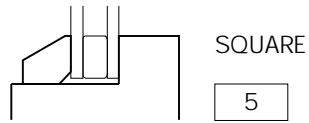

LAMINATED SAFETY GLASS

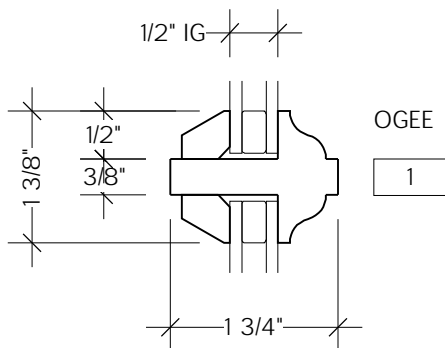
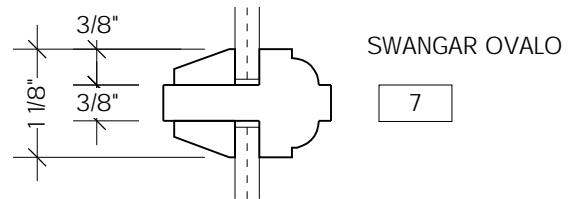

LAMINATED SAFETY GLASS

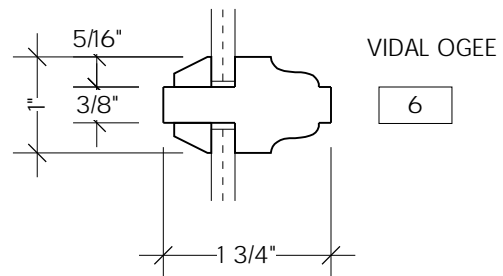

STD STOP GLAZED, 1/2 IG

----- SHORT DASHED LINE INDICATES BY OTHERS

SASH STICKING PROFILES	1/2 FULL SIZE		7/14/04
STANDARD DETAILS	SEBASTOPOL WINDOW COMPANY	APPROVED	SHEET 2.41

DATE

StdetWEB.mcd

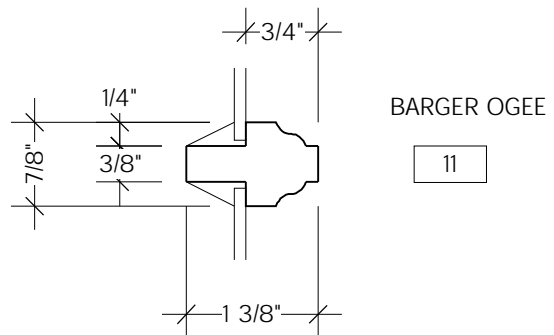
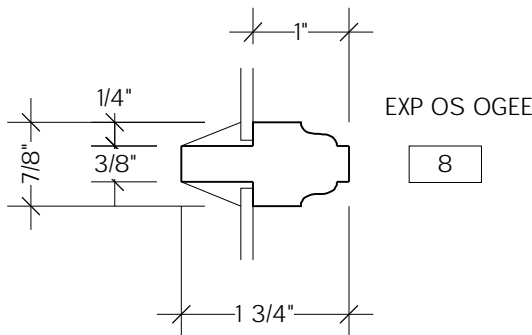
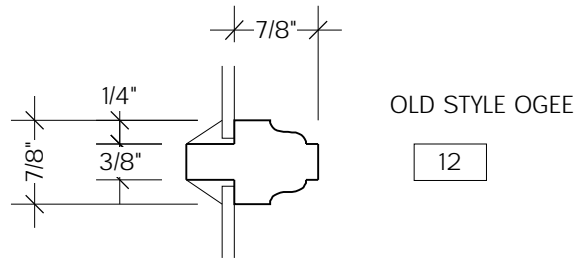
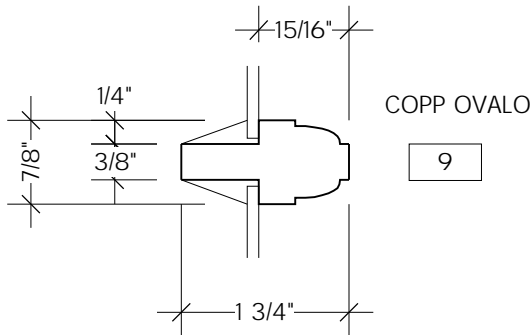
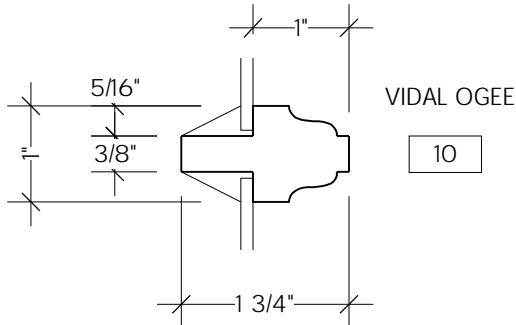

PUTTY GLAZED, 1/8 GL

----- SHORT DASHED LINE INDICATES BY OTHERS

SASH STICKING PROFILES	1/2 FULL SIZE		7/14/04
STANDARD DETAILS	SEBASTOPOL WINDOW COMPANY	APPROVED	SHEET 2.42
		DATE	

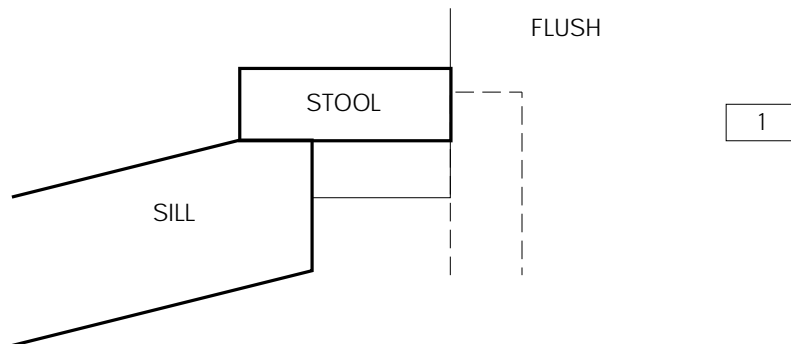
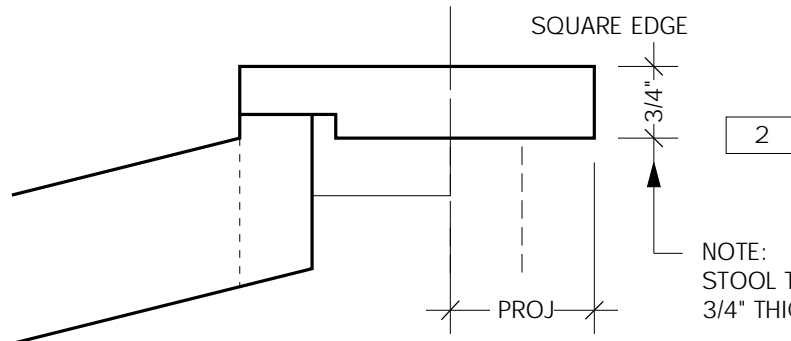
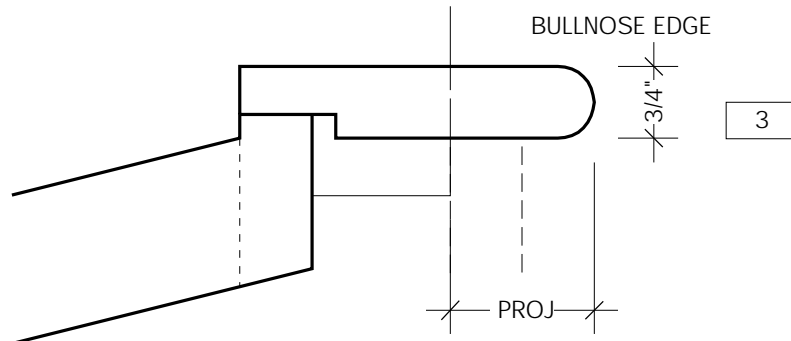
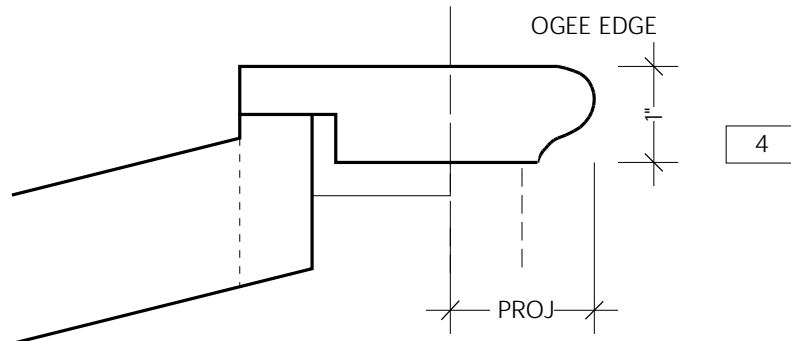

NOTE: PROJECTING STOOLS W/ HORNS ARE SUPPLIED LOOSE

NOTE:
STOOL THICKNESS MAY VARY
3/4" THICK IS TYPICAL

----- SHORT DASHED LINE INDICATES BY OTHERS

WINDOW STOOL PROFILES	1/2 FULL SIZE		7/14/04
STANDARD DETAILS		APPROVED	SHEET 2.51